

GM-I FORMALDEHYDE EXPANSION CARD

(Accessory for ISQ, ISQ-F & ISQ-V)

INTRODUCTION

The GM-I is a sensor that measures the formaldehyde (CHOH) concentration in room air. The sensor is designed for installation in the active air supply units ISQ, ISQ-F, and ISQ-V. Formaldehyde belongs to the group of particularly notable volatile organic compounds (VOC).

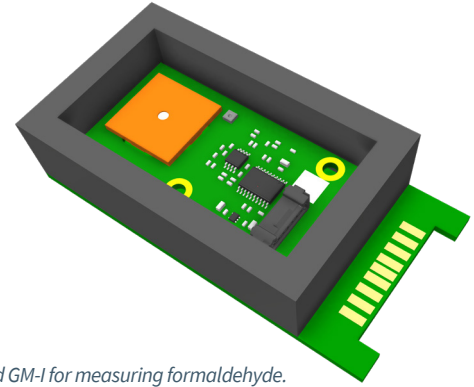

Expansion card GM-I for measuring formaldehyde.

APPLICATIONS

The GM-I is used for monitoring the formaldehyde concentration in inhaled air. Based on the measured concentration, functions such as alarms and adjustment of air supply volume can be activated.

INSTALLATION AND CONNECTION FOR ISQ/ISQ-F

A cable and a mounting plate are included in the delivery.

1. Remove a protective film on the inside of the diffuser cover, under the electronics holder, where the expansion card mounting location is.
- 2-3. Insert the GM-I and secure the module with the mounting plate. Ensure the unit is parallel to the diffuser plate.

Connection: Via cable to the expansion card port according to the connection diagram.

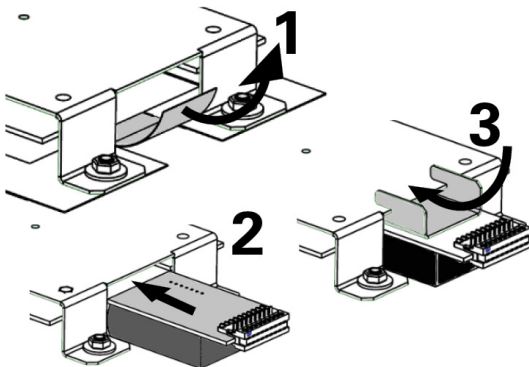

Mounting GM-I in the Expansion Module Location on the Inside of the Diffuser Cover for ISQ and ISQ-F.

TECHNICAL SPECIFICATIONS

Generel

Formaldehyde Measurement

Measurement range: 0 - 1000 ppm

Accuracy: ± 20 ppm or $\pm 20\%$ of the measured value

Operating Temperature Limits: 0°C to 40°C

Operating Humidity Limits: 10% to 90% RH

Dimensions: 69 x 35 x 17 mm (L x W x H)

Weight: 30 g (Including cable and mounting plate)

Cable

Included

Material

Circuit Board: FR4

Cable: Polyolefin, Halogen-free (EN 60754-1/2, IEC 60754-2)

A cell rubber collar is applied to the unit as part of the mounting arrangement.

Electrical System

Power Suooly: 5 V

Power Consumption: 0,1 VA

CE Marking: Complies with EMC and low voltage directives.

IP Class: IP10

Input and Output Signals

Output Signal

Communication bus I2C.

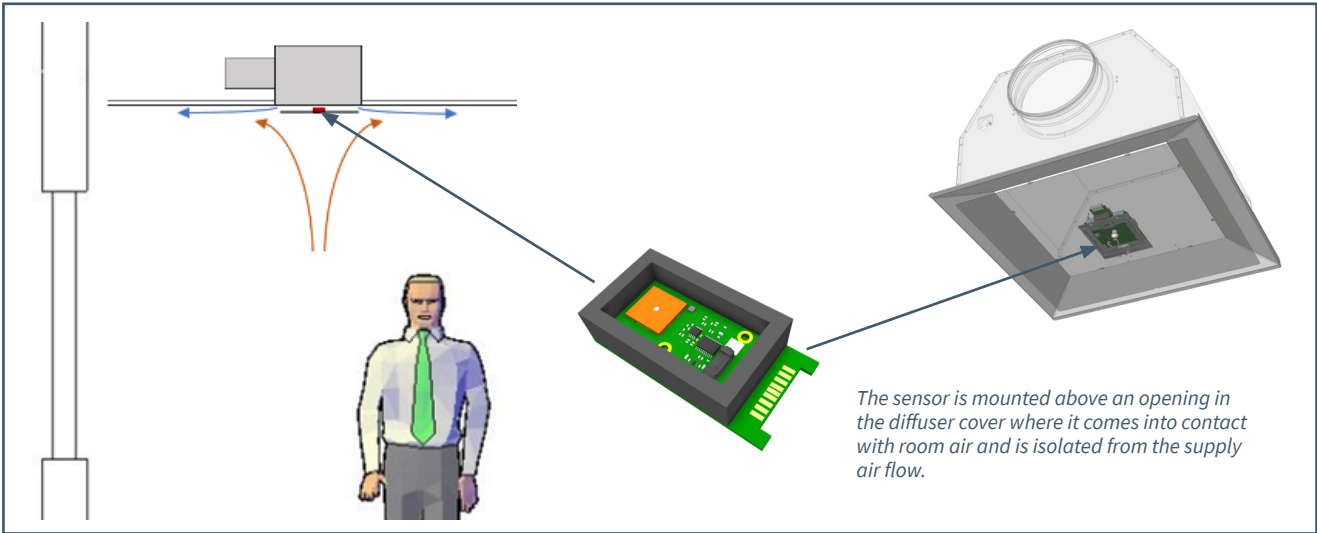

The GM-I expansion card is placed inside the diffuser cover of the ISQ unit.

CONNECTION

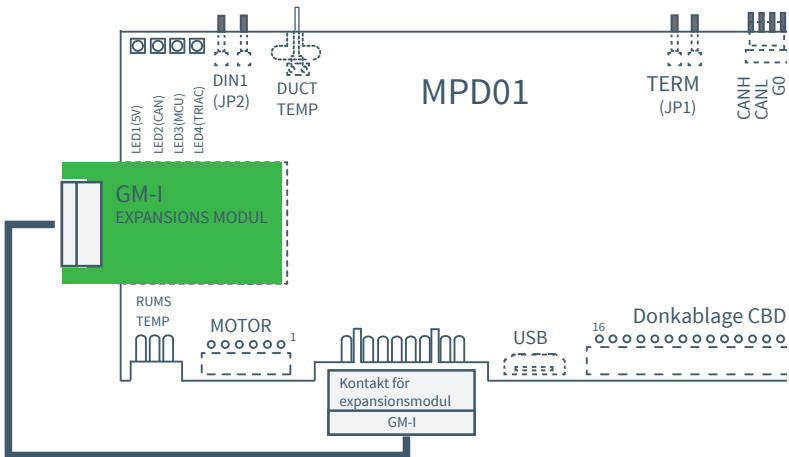

Section showing the connection of the GM-I to the expansion card socket under the circuit board holder on the ISQ diffuser cover.

ADDITIONAL PRODUCT DOCUMENTATION

Documents are available at www.lindinvent.com

Document	Comment
Installation Instructions	See installation and connection instructions here in the product description for GM-I.
Commissioning Instructions	See commissioning instructions for the control unit to which the occupancy sensor is connected.
Maintenance Instructions	Considered maintenance-free.
External Connection Diagram	Shows connection to the circuit board on the diffuser plate of the active unit.
Environmental Product Declaration	For assessment by the Bygghälsöversyn in Sweden.
AMA Text	New version coming soon.