

## CBD Junction Box for Active Air Supply Device

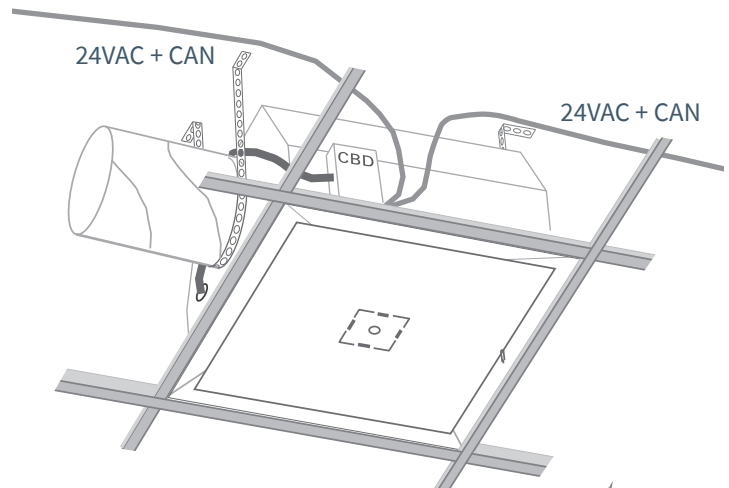

*CBD - Junction Box for Active Air Supply Device*



*CBD Junction Box connected to ISQ and the communication loop (CAN) with conductors for power supply (24 VAC).*

### Preparations

- The CBD is delivered attached via magnets to the ISQ.
- The device's cable is usually connected to the CBD upon delivery. If the device cable is not connected, the pre-terminated cable can be easily connected to the designated terminal in the CBD. Follow the instructions under the connection section below.
- Check that the cabling from the ISQ is well secured in the device box. The cable gland should be locked in place with the retaining plate at the cable entry hole of the device box as delivered.
- If necessary, loosen the cable reel on the device cable to facilitate connections in the box and to place the box on the device box where it is most practical.
- Lindinvent's 4-conductor cable for communication and power supply is routed according to the current electrical drawing documentation.

The standard length of the device cable is 1 meter, suitable for mounting the CBD on the device box. The CBD can be installed elsewhere, but at a distance not exceeding 10 meters from the active device.

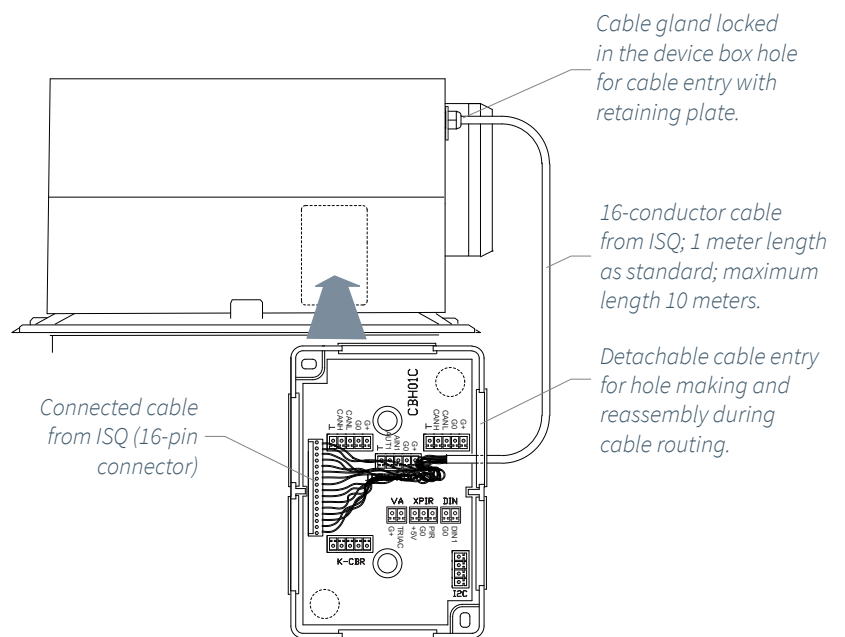

*Illustration 1M – CBD Junction Box ready for connection of communication loop with 24 VAC and equipment. The cover of the CBD is removed for access to connectors. The cable from the ISQ is connected.*

## CBD Junction Box for Active Air Supply Device

### Connection and Installation

1. Remove the cover from the CBD. The unit consists of a circuit board with connectors mounted in a double box, see illustration 1M.
2. The communication loop (CAN) with conductors for power supply (24 VAC) and any accessories to the ISQ are connected to the designated terminal in the CBD. Conductors should be connected as needed with guidance from the color codes on the screw terminal. See the external wiring diagram below. The shield should be insulated. Route cables through the appropriate cable entry in the CBD. Cable entries in the CBD are loosened for hole making and placed back in the box when the cabling is in place.
3. Replace the cover on the CBD.
4. Place the CBD on the ISQ. The CBD, equipped with magnets, can be positioned where it is most suitable considering the connected cables.

### External Wiring Diagram

Connections of conductors to the CBD should be made according to the external wiring diagram below.

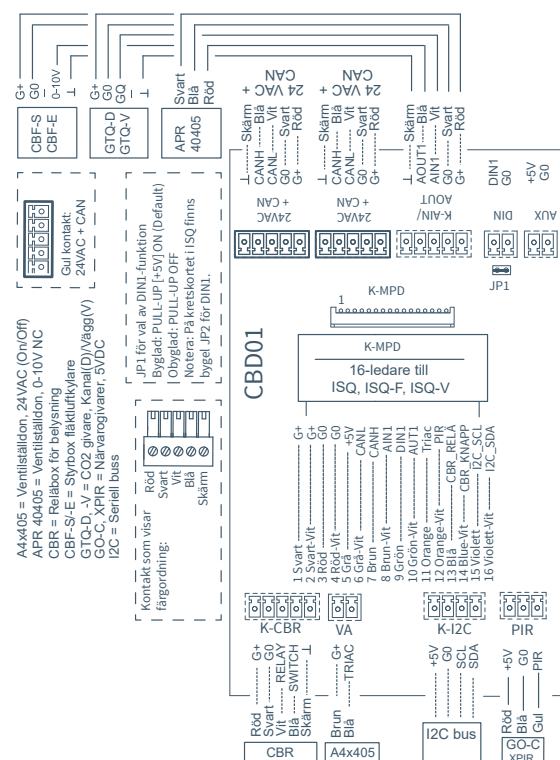

Illustration 1I. The external wiring diagram shows how equipment is connected. The wiring diagram is labeled on the inside of the CBD cover.