

The enclosure is designed for installation over a wall-mounted electrical box.

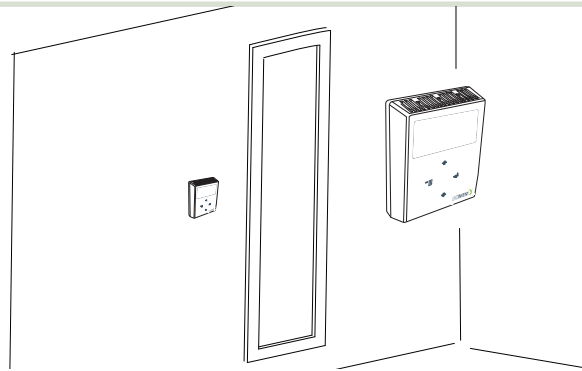

## INSTALLATION

The DRP is mounted on the wall.

1. The cover, which contains the display and other electronics, is removed via the snap mechanism at the bottom edge. When opened, the DRP consists of the cover and the corresponding base.
2. If necessary (when no electrical box is present or cannot be used), make an opening at the edge of the base for the CAN cabling. The base is screwed into place in the designated location in the room for temperature measurement.

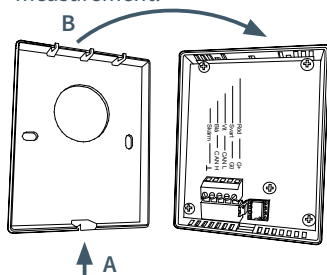

Illustration 1M. The DRP is opened by pressing in point A with a screwdriver or similar tool and then unhooking the cover at point B.

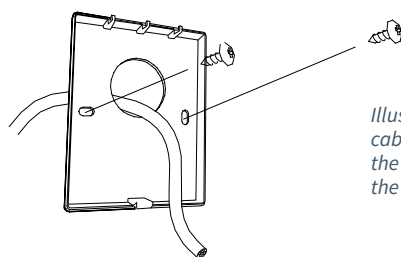

Illustration 2M. The cabling is fed in, and the base is screwed to the wall.

3. The cable, a 4-conductor with shield, is connected to the circuit board following the wiring diagram on page 3.

The cover is reattached by positioning the top edge of the cover and then snapping the bottom edge into place using the snap fastening.

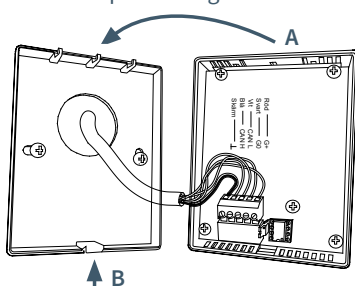

Illustration 3M. After connecting the wires according to the external wiring diagram, the installation is completed by reattaching the cover.

## CONNECTION

The DRP is connected to the CAN bus with 24 VAC according to the wiring diagram below.

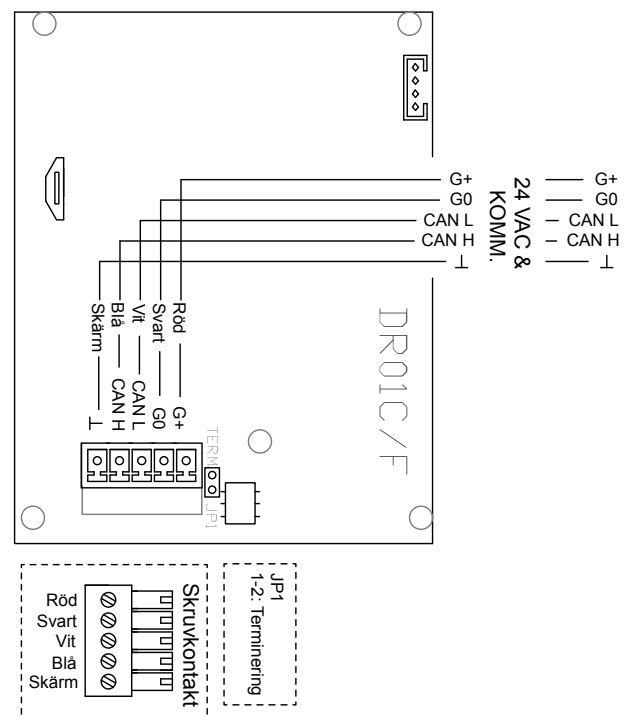

Illustration 1I. External wiring diagram for DRP version B01.